

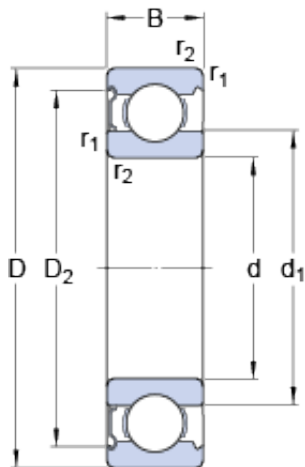

# BEARING INDUSTRIA CUSCINETTI S.P.A.



65 mm x 120 mm x 23 mm skf 6213-Z Deep groove ball bearings

Bearing No. 6213-Z

6213-Z Bearing 2D drawings and 3D CAD models

Size	120x65x23 mm
Bore Diameter	120 mm
Outer Diameter	65 mm
Width	23 mm
d	65 mm
D	120 mm
B	23 mm
d <sub>1</sub>	83.3 mm
D <sub>2</sub>	105.8 mm
r <sub>1,2</sub> - min.	1.5 mm
d <sub>a</sub> - min.	74 mm
d <sub>a</sub> - max.	83.2 mm
D <sub>a</sub> - max.	111 mm
r <sub>a</sub> - max.	1.5 mm
Basic dynamic load rating - C	58.5 kN
Basic static load rating - C <sub>0</sub>	40.5 kN
Fatigue load limit - P <sub>u</sub>	1.7 kN
Reference speed	12000 r/min
Limiting speed	7500 r/min
Calculation factor - k <sub>r</sub>	0.025
Calculation factor - f <sub>0</sub>	14.7
Category	Single Row Ball Bearings
Inventory	0.0
Manufacturer Name	SKF



## BEARING INDUSTRIA CUSCINETTI S.P.A.

Minimum Buy Quantity	N/A
Weight / Kilogram	1.043
Product Group	B00308
Enclosure	1 Metal Shield
Precision Class	ABEC 1   ISO P0
Maximum Capacity / Filling Slot	No
Rolling Element	Ball Bearing
Snap Ring	No
Internal Special Features	No
Cage Material	Steel
Internal Clearance	C0-Medium
Inch - Metric	Metric
Long Description	65MM Bore; 120MM Outside Diameter; 23MM Outer Race Diameter; 1 Metal Shield; Ball Bearing; ABEC 1   ISO P0; No Filling Slot; No Snap Ring; No Internal Special Features
Category	Single Row Ball Bearing
UNSPSC	31171504
Harmonized Tariff Code	8482.10.50.68
Noun	Bearing
Keyword String	Ball
Manufacturer URL	<a href="http://www.skf.com">http://www.skf.com</a>
Manufacturer Item Number	6213-Z
Weight / LBS	2.3
Outer Race Width	0.906 Inch   23 Millimeter
Outside Diameter	4.724 Inch   120 Millimeter
Bore	2.559 Inch   65 Millimeter
bore diameter:	65 mm
static load capacity:	40.5 kN
outside diameter:	120 mm



## BEARING INDUSTRIA CUSCINETTI S.P.A.

precision rating:	Not Rated
overall width:	23 mm
finish/coating:	Uncoated
bore type:	Round
cage material:	Steel
closure type:	Single Shield
outer ring width:	23 mm
row type & fill slot:	Single Row Non-Fill Slot
fillet radius:	1.5 mm
internal clearance:	C0
maximum rpm:	6000 RPM
dynamic load capacity:	58.5 kN
series:	62
$d_1$	83.3 mm
$D_2$	105.8 mm
$r_{1,2}$ min.	1.5 mm
$d_a$ min.	74 mm
$d_a$ max.	83.2 mm
$D_a$ max.	111 mm
$r_a$ max.	1.5 mm
Basic dynamic load rating C	58.5 kN
Basic static load rating $C_0$	40.5 kN
Fatigue load limit $P_u$	1.73 kN
Calculation factor $k_r$	0.025
Calculation factor $f_0$	14.7
Mass bearing	1.03 kg